

DOOR GASKET INSTALLATION INSTRUCTIONS

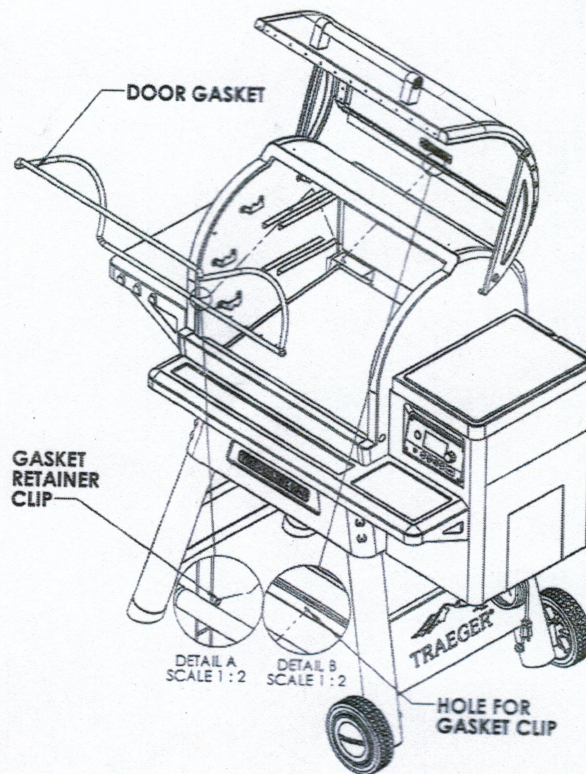

CAUTION! Do not attempt to replace parts unless you are qualified to do so. If you require help in replacing parts please feel to contact Traeger Customer service at: 1-800-872-3437 between the hours of 5AM PST to 7PM PST 7 days a week.



Installation Instructions:

1. Insert door gasket onto door by first inserting the gasket retaining clip closest to the end into the hole located closest to the center of the door.
2. Insert the other clips one at a time into the next hole until you get all the way around the door.
3. Then you will want to cut the excess gasket off and insert one end into the center portion of the other end of the gasket to complete the seal.